



## 3D CAD/CAM

**An indispensable asset for  
the Offsite Construction Industry**

hsbcad provides flexible software solutions for the offsite construction industry. Our CAD/CAM products and services are tailored to support your production methods and technologies, from design to construction.

**Discover our software solutions**

[www.hsbcad.com](http://www.hsbcad.com)





Holzbau Vorholz Hawran GmbH

Ducret, Orges.

Design: Maeda Corporation, NAKAI ARCHITECT & ASSOCIATES, Modern Architecture Institute Holzstr  
Wood Construction: Maeda Corporation, HASEGAWA CORPORATION  
Framework: CHUTO

# Empowering you to realise

Rafter Productionplan  
M 1:20

Wood Construction  
The advantage of native BIM workflow is that all applications work on the same platform, without any loss of data. Many third-party applications explore the functionality of BIM. Examples: linked with functions for advanced wood construction.

Detail HB 1  
M 1:10

3D Detail View

3D Ridge detail

Ridge Connection  
M 1:10

Roof Construction of Main Building  
M 1:20

Roof 1  
M 1:20

3D Part of Roof

| Dachstuhl Holzmenge |       |
|---------------------|-------|
| Material            | Menge |
| 100                 | 100   |
| 200                 | 200   |
| 300                 | 300   |
| 400                 | 400   |
| 500                 | 500   |
| 600                 | 600   |
| 700                 | 700   |
| 800                 | 800   |
| 900                 | 900   |
| 1000                | 1000  |

**Detail of Wood Construction**  
M 1:10

**Roof Construction of Main Building**  
M 1:20

| REVISIONEN |       |              |
|------------|-------|--------------|
| NOX        | DATUM | BESCHREIBUNG |
|            |       |              |

|                                |                     |
|--------------------------------|---------------------|
| NAME: GOLDEN NUGGET            | NAME: GOLDEN NUGGET |
| PROJNR: 2019-03                | PROJ: 2019-03       |
| PLANWALT: PLANWALT             | DATE: 24.03.2019    |
| PLANVERFASSTER: PLANVERFASSTER | DATE: 24.03.2019    |

**In 3 steps, hsbcad™ provides all the information to all flows in order to export to CNC machines.**

**Step 1:**  
Start the function hsbcad Exporter and specify filename and folder

**Step 2:**  
Select objects to be exported

**Step 3:**  
Select the export-format

**CNC file ready!**

**Product is ready!**

hsbcad provides flexible tools for the offsite construction industry that stem from design, to manufacture and finally to construction. hsbcad's uniqueness is your benefit, in that it does not constrain to any specific building design, machinery selection or production method. It is totally flexible!



## The most powerful detailing software

hsbdesign is a collaborative (BIM) software where designers, project engineers, production and site teams help each other detail projects for the offsite construction industry.

### CAD

Design your project with hsbcad using Autocad Architecture® or Autodesk Revit® for maximum user experience and familiarity.

### DETAIL

Using our large arsenal of tools, your design and detailing options become truly limitless.

### CAM

Manufacture your detailed design with automated CNC, shop drawings and bill of materials.

## Compatible with your favourite software

### A AUTOCAD ARCHITECTURE

hsbdesign for Autocad Architecture® is our core software for which we developed all our solutions since 1988 and will passionately continue to do so.

### R REVIT

hsbdesign for Autodesk Revit® is our up and coming software that continues to grow with features and benefits. Our solution remains the same, the environment different.

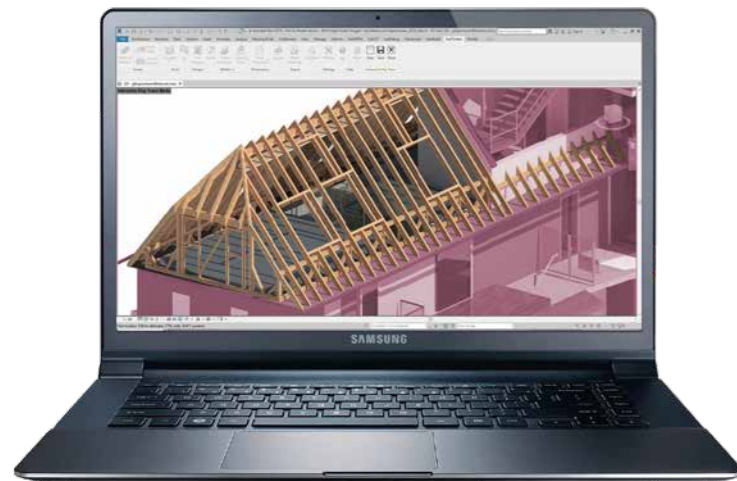

#### Up to date with ever-evolving market

We continuously update the software to meet the latest industry standards, making sure you are always ahead.



#### Endless customisability

Our software is praised by many for its flexibility, adapting our solutions to your way of working to ensure a seamless experience.



#### Familiar with ACA and REVIT environment

hsbdesign functions inside the AutoCAD Architecture® and Autodesk Revit® environment, offering maximum familiarity.

### BIM

#### Building Information Modelling

hsbcad meets the latest BIM standards, ensuring all stakeholders of your projects can virtually collaborate to ensure an excellent end result.

## We empower these construction methods

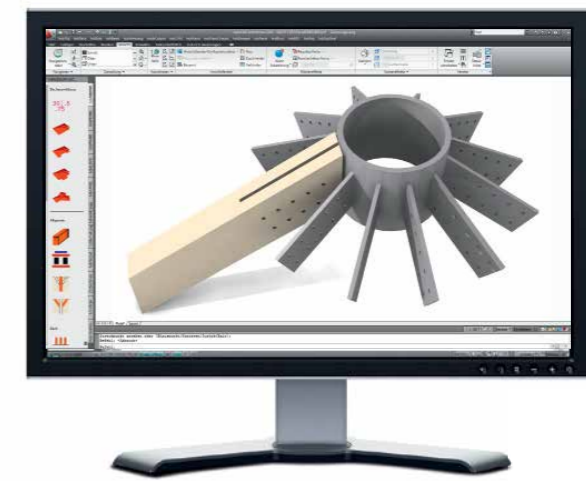
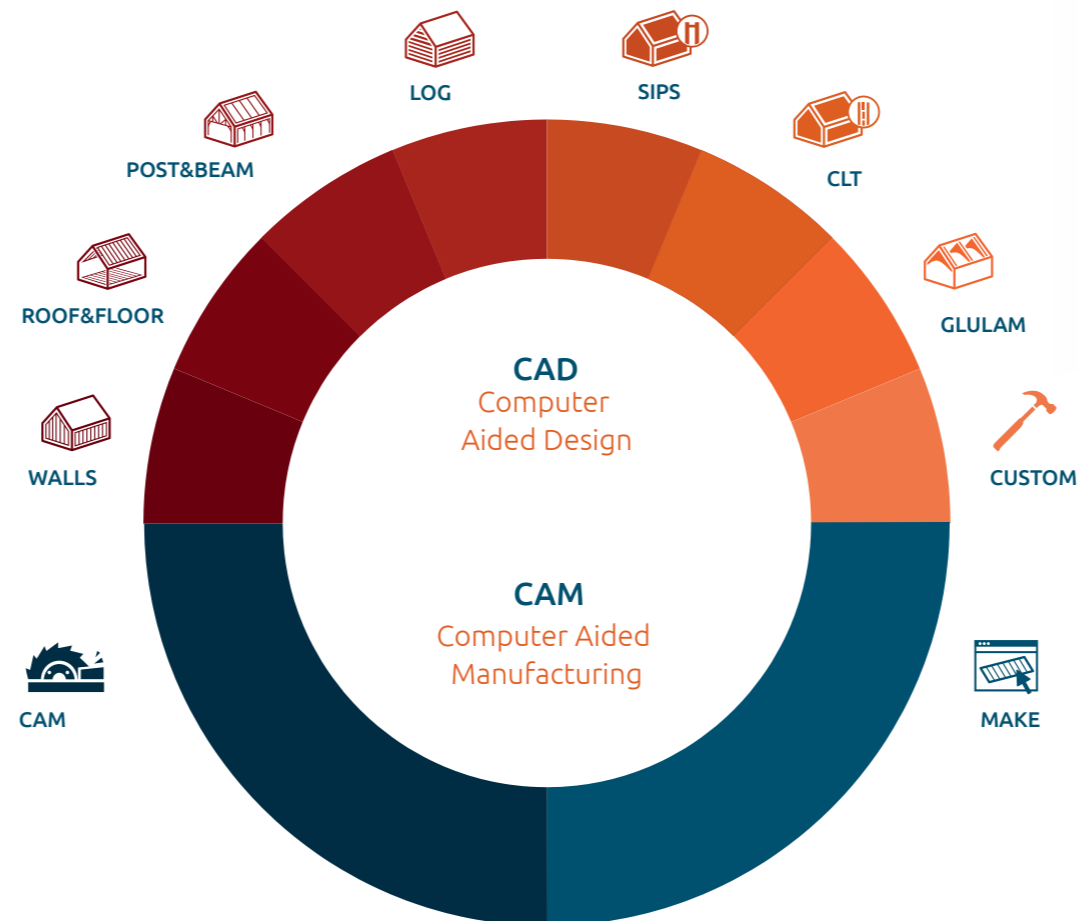

At hsbcad, we continuously adopt the latest BIM trend, together with our construction partners, providing you with all the detailing possibilities to complete your project design

## Unique features

- One 3D Environment
- Parametric tools
- Hybrid construction
- All things BIM compliant

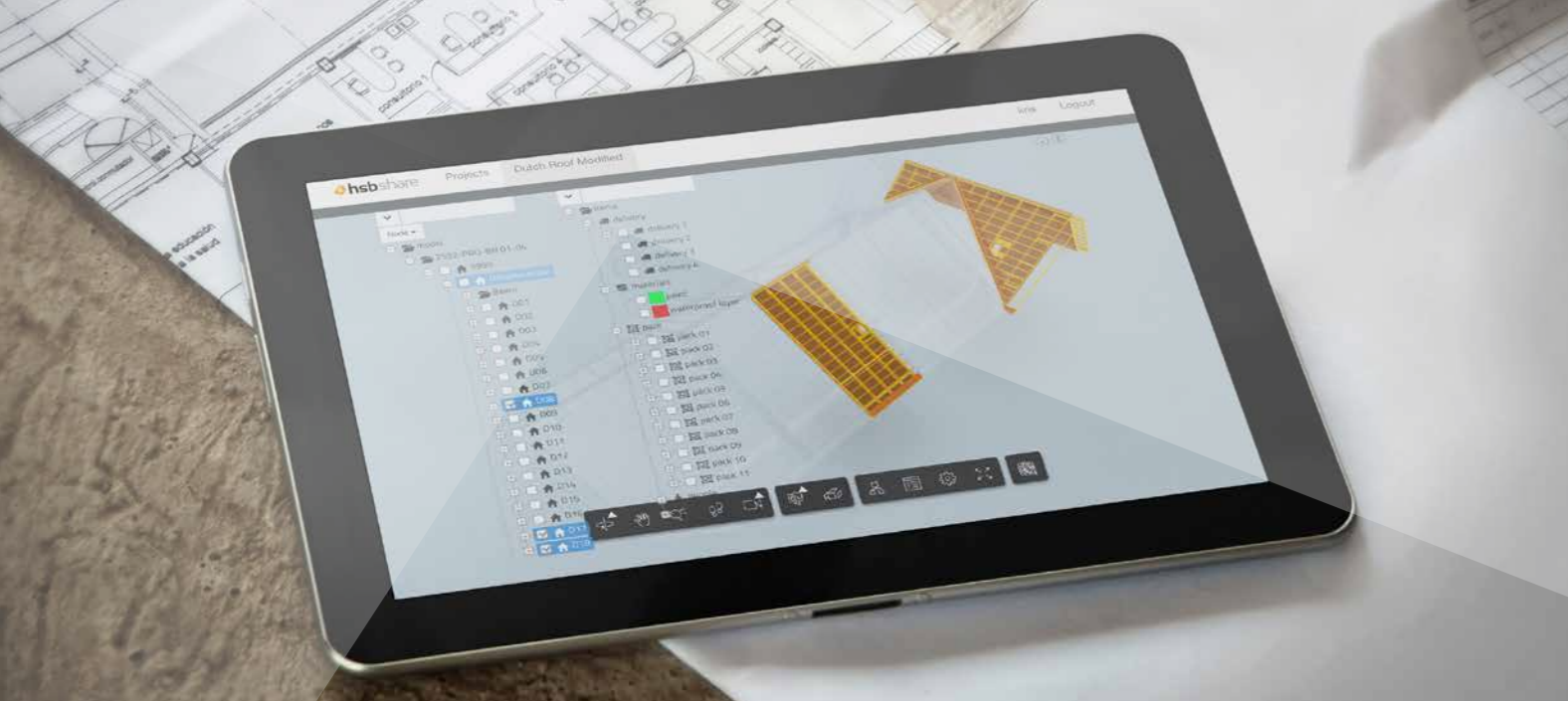

## hsbshare

### Connect, share and reach for the cloud

Bring all stakeholders together on one centralised platform, from first designs made to a finalised construction.

#### BIM

##### Building Information Modelling

Unify all project data into your BIM cloud platform, making it accessible from anywhere by anywhere by all stakeholders.



##### Connect all stakeholders

Communicate on one shared platform, optimize collaboration and prevent any mistakes, together.



##### Customise to your needs

Adapt hsbshare to your company's way of working and stay true to your company DNA.



##### Visualise what's needed

Follow up on projects using real-time 3D views. Add remarks, files and issues for the entire team to review.



##### Paperless off-site experience

No more printed paper. Enrich your files with limitless possibility.



##### From design to construction

Go digital for maximum optimization of your construction process, from first line drawn to final part installed.

### Unique features

- Layout tailored to your needs
- Design reviews
- Customisable reporting
- Direct reporting from the construction site
- Urgent projects first
- Leave remarks and notes

## hsbmake

### Empowering your production

Improve your production efficiency and remove cost by simplifying and automating your production process.



##### Improve efficiency

Our solution allows you to schedule, route and manage production for optimal workflow effectiveness.



##### Have complete control

Release production jobs to your shop floor, prioritising urgent tasks first.



##### Monitoring & gain insight

Gain an overview of your production and generate automated reports to identify key bottlenecks.



##### Visualise what's needed

Generate 3D views highlighting the relevant details per workstation, helping your team focus on what is important.



##### Remove human error

Quickly adapt designs without slowing down production. Never load any files manually again.



##### Customise to your needs

We tailor our solution to your company DNA, keeping your culture and tradition unchanged, yet empowering your process.

### Unique features

- Targeted reports
- Simplified production drawings
- Shop floor overview
- Focus on your design
- Urgent projects first

*“StructureCraft has now been working with hsbcad for the past 2 years, and it has completely changed how we design detail mass timber structures. The automation capabilities are a significant part of the reason we chose to go with hsbcad, and they have delivered, enabling us to efficiently create high level of detail 3D models of some of North America’s most complex mass timber projects. With the upcoming launch of online 3D model sharing capabilities and 4D BOM planning, we see hsbcad supporting our growing business in the years to come.”*

**Lucas Epp — Engineering & 3D Manager**  
**StructureCraft Builders Inc.**

*“We have been using hsbcad for the last decade. The short links to our CNC machine have proved its efficiency in the design process. Using hsbcad ensures us to develop in the future BIM constructions.”*

**Jean-Marc Ducret — General Manager**  
**JPF Ducret**

*“Autodesk is delighted to partner with hsbcad on their new Revit based BIM solution for timber. hsbcad’s offering extends Revit’s detailed design capabilities to fabrication, allowing Revit users to enhance the BIM-to-fabrication workflow. Autodesk is pleased to have hsbcad as a partner in leading industry progress toward the accelerating industrialization of construction.”*

**Gary Wyatt — Director of Industry Strategy for building design at Autodesk**  
**Autodesk**

• **hsbcad BVBA, BELGIUM**  
**Head Office**  
Brouwerijstraat 1  
9031 Drogen  
Belgium

info@hsbcad.com  
+32 (0)9 2212245

• **Additional offices in:**  
United Kingdom  
Germany  
The Netherlands  
Japan  
Ecuador  
USA  
Canada  
Australia  
New Zealand.

• **Representatives in:**  
Italy  
Norway



Photo: Johann Jartz

